

CONFERENCES & EVENTS



V111423

LOADING DOCKS/ FREIGHT ELEVATORS

Four-bay loading dock on Wabash Avenue. All cars support a maximum capacity of 20,000 lbs.

BAY 1:

- Serviced by Car #28. Access from Wabash Avenue. Dimensions of fold-down metal door is 12'H x 15'5"W. This car serves all four Salons in the Stevens Meeting center.

BAY 2:

- Serviced by Car #25 and additional service elevators. Access from Wabash Avenue. Dimensions of roll-down metal doors are 11'9"H x 12'4"W and 12'H x 12'5"W. Height of staging areas is 3'4". This car serves the Grand Ballroom, International Ballroom, and Stevens Salon C.

BAY 3:

- Serviced by Car #25 and additional service elevators. Access from Wabash Avenue. Dimensions of roll-down metal doors are 11'9"H x 12'4"W and 12'H x 12'5"W. Height of staging areas is 3'4". This car serves the Grand Ballroom, International Ballroom, and Stevens Salon C.

BAY 5:

- Serviced by Car #27. Sidewalk access from Wabash Avenue. Freight car is located south of main loading dock area. Interior dimensions of car are: 27'3"L x 11'10"W x 9'10"H. Dimensions of doors are 9'10"H x 12'W. This car serves the Continental Room and Stevens Salons A, C, and D.

PERMANENT SCREENS

- International Ballroom — (3) 20' x 18' electric screens centered on west wall
- Grand Ballroom — 20' x 20' electric screen centered on east wall
- McCormick Board Room — 8' x 8' electric screen centered on south wall
- Pullman Board Room — 8' x 8' electric screen centered on south wall

DANCE FLOORS

- Portable dance floors can be set in any desired room.

Each section measures 4' x 4'.

PREFUNCTION SQUARE FOOTAGE

LOWER LEVEL

- Salon A, pre-function - 5,060sqft
- Salon C, pre-function - 6,208sqft

LOBBY LEVEL

- Continental Room Foyer — 144' x 25' = 3,600ft²

SECOND FLOOR

- Grand Foyer — 86' x 29' = 2,494ft²
- International Foyer — 103' x 18' = 1,854ft²
- Normandie Lounge — 130' x 28' = 3,640ft²
- Boulevard Foyer — 36' x 30' = 1,080ft²

THIRD FLOOR

- Marquette Foyer — 28' x 13' = 364ft²
- Joliet Foyer — 33' x 13' = 429ft²

COLUMN SIZES

LOWER LEVEL — STEVENS MEETING CENTER

- Stevens Salon A 4'4" x 3'4"
- Stevens Salon B 3' x 2'6"
- Stevens Salon C 4'6" x 4'6"-5'
- Stevens Salon D 2'2" x 2'2"- 2'8"

THIRD FLOOR



- PDR 4 3' x 4'
- Williford Room 2'6" x 2'6"
- Waldorf Room 2'8" x 2'4"
- Astoria Room 2'5" x 2'3"

FOURTH FLOOR

- Conference Room 4D 3'7" x 2'1"

	LED	Flourescent	Incandescent	Cans	Chandeliers	Chandelier Clearance	Location of Controls	Built in Sound	Fans
Lighting & Sounds									
LOWER LEVEL									
Stevens Meeting Center: Salons A, B, C, D"	•	•					Inside Door	•	
Mobley Room			•	•			Inside Pillar	•	•
LOBBY LEVEL									
Continental Room: A, B, C	•				•	12'	Inside Door	•	
Grand Tradition	•		•	•			Inside Door	•	
SECOND FLOOR									
Gand Ballroom	•		•		•	15'3"	North Wall	•	
International Ballroom	•				•	19'4"	SE & NW Walls	•	
Boulevard Room: A, B, C	•				•		Inside Door	•	
Normandie Lounge	•				•	12'	South Wall	•	
THIRD FLOOR									
Waldorf Room	•		•	•	•	9'11"	Inside Door	•	
Astoria Room	•		•	•	•	9'6"	Inside Door	•	
Williford Room: A, B, C	•				•		Inside Door	•	
Marquette Room	•		•		•	7'11"	Inside Door		
Joliet Room	•		•		•	7'3"	Inside Door	•	
PDR 1-4	•		•	•	•	7'2" - 7'5"	Inside Door	•	
PDR 5-7	•		•	•	•	7'5"	Inside Door		
FOURTH FLOOR									
4A-4R	•		•				Inside Door		
McCormick	•		•	•			Inside Door		
Pullman	•		•	•			Inside Door		
FIFTH FLOOR									
All rooms 5A-1	•		•	•			Inside Door		
EIGHTH FLOOR									
Lake Ontario	•		•	•			Inside Door	•	
Lake Michigan	•		•	•			Inside Door	•	
Lake Huron	•		•	•			Inside Door	•	
Lake Erie	•		•	•			Inside Door	•	
24th FLOOR									
Grant Park Parlour	•		•	•			Inside Door		

KEY

-  Meeting/Conference Rooms
-  Amenities
-  Heart of House

EIGHTH FLOOR

- LAKE ERIE
- LAKE HURON
- LAKE MICHIGAN
- LAKE ONTARIO

FIFTH FLOOR

- 5I
- 5H
- 5C
- 5G
- 5F
- 5E

- 5D
- 5B
- 5A

FOURTH FLOOR

- 4R, 4Q, 4P
- 4L
- 4K
- 4M

- 4G, 4H, 4I, 4J

PULLMAN BOARDROOM

THIRD FLOOR

- PRIVATE DINING ROOMS 5-7
- JOLIET
- MARQUETTE

- 4E, 4F
- McCORMICK BOARDROOM
- 4A, 4B, 4C, 4D

WALDORF

PRIVATE DINING ROOMS 1-4

SECOND FLOOR

- INTERNATIONAL BALLROOM
- GRAND BALLROOM
- GRAND BALLROOM FOYER
- NORMANDIE LOUNGE

ASTORIA
WILLIFORD ROOM

BOULEVARD FOYER
BOULEVARD ROOM

LOBBYLEVEL

- CONTINENTAL ROOM
- CONTINENTAL FOYER
- 8TH STREET SOUTH REGISTRATION
- 8TH STREET NORTH REGISTRATION
- BUCKINGHAM ROOM

Escalator Access to
International Ballroom

GRAND TRADITION

LOWER LEVEL

- SALON D
- SALON C

SALON A

SALON B
MOBLEY ROOM



**STEVENS
MEETING
CENTER**

	Square Feet	Square Meters	Dimensions L x W	Ceiling Height Max*	Ceiling Height Max Meters	Ceiling Height Min.	Ceiling Height Min. Meters	Column Size	Floor Load	Floor Surface	8' x 10' Booths	10'x10' Booths	Banquet 10/60"
Salon A	40,140	3729.13	195'x200'	11' 4"	3.18	10'	0.93	4'4"x3'4"	100 lbs/sq. ft.	Carpet	144	139	2,000
Salon B	9,204	855.08	176'x96'	9.5' 5"	2.87	8.5' 5"	0.79	3' x 2'6"	100 lbs/sq. ft.	Carpet	26	26	180
Salon C	28,906	1986.64	200'x149'	10'2"	3.10	10'2"	0.95	4'6"x4'6"-5'	100 lbs/sq. ft.	Carpet	88	98	1,000
Salon C, Office A	112	10.41	14'x8'	10'2"	3.10	10'2"	0.95	-	-	Carpet	-	-	-
Salon C, Office B	330	30.66	33'x10'	10'2"	3.10	10'2"	0.95	-	-	Carpet	-	-	-
Salon D	34,884	3240.83	205'x170'	10'	3.05	8'9"	0.83	2'2"x2'2"x2'8"	100 lbs/sq. ft.	Carpet	113	108	1,100







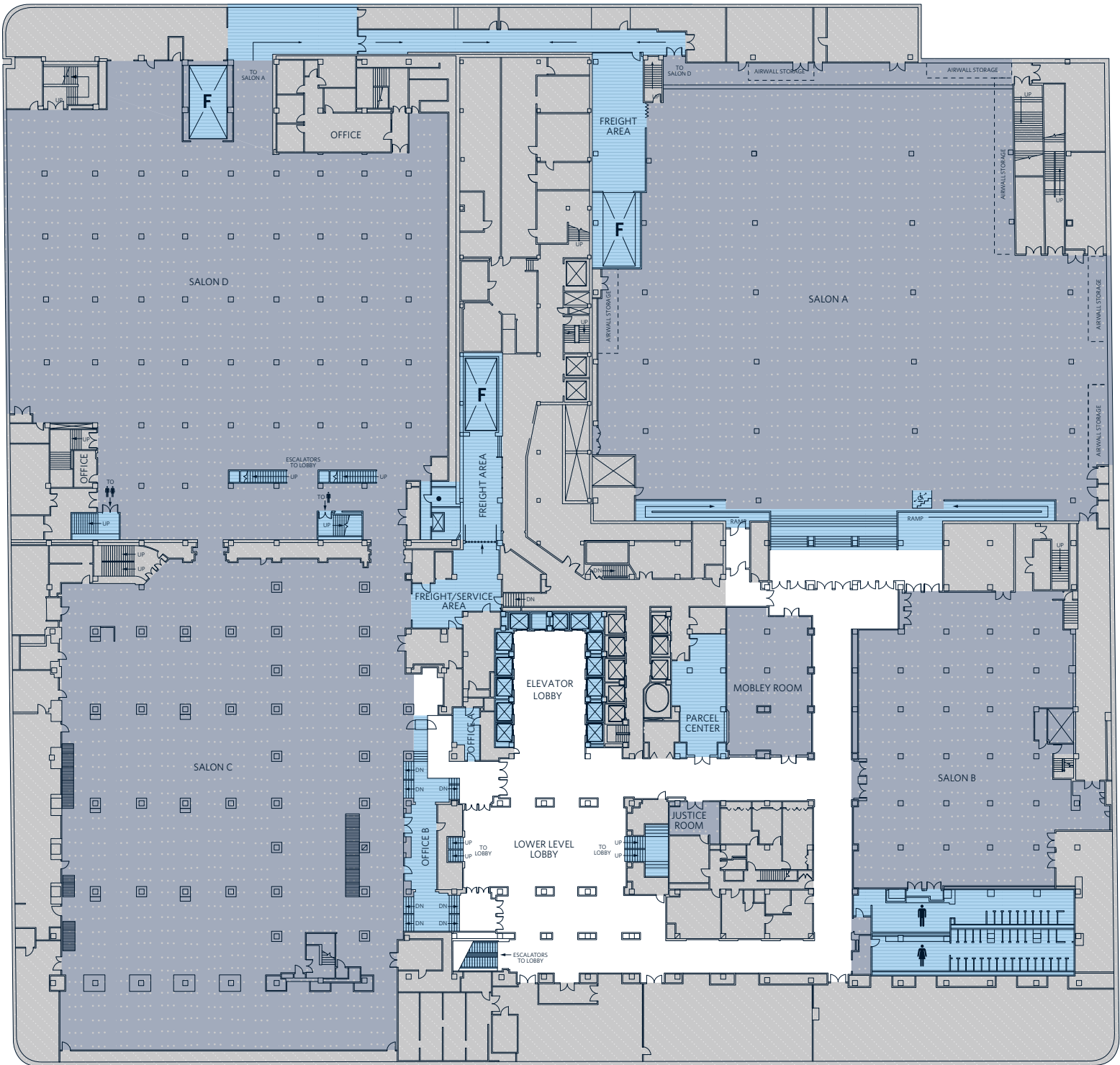

*All capacities are based on usable square footage

	Square Feet	Square Meters	Dimensions L x W"	Ceiling Height	Ceiling Height Meters	Theater	School Room 2/6'	School Room 3/6'	Banquet 10/60"	Reception	Conference
Mobley Room	1,972	183.20	34'x58'	8'6"	2.59	65	24	36	80	150	28
Justice Room	320	29.73	16'x20'	7'11.5"	2.41	-	-	-	-	-	-

*All capacities are based on usable square footage



KEY

- | | |
|--|--|
|  Meeting/Conference Rooms |  ADA Elevator |
|  Amenities |  ADA Lift |
|  Heart of House |  Restrooms |
| |  Elevator |
| |  Freight Elevator |

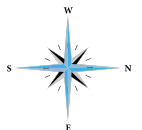





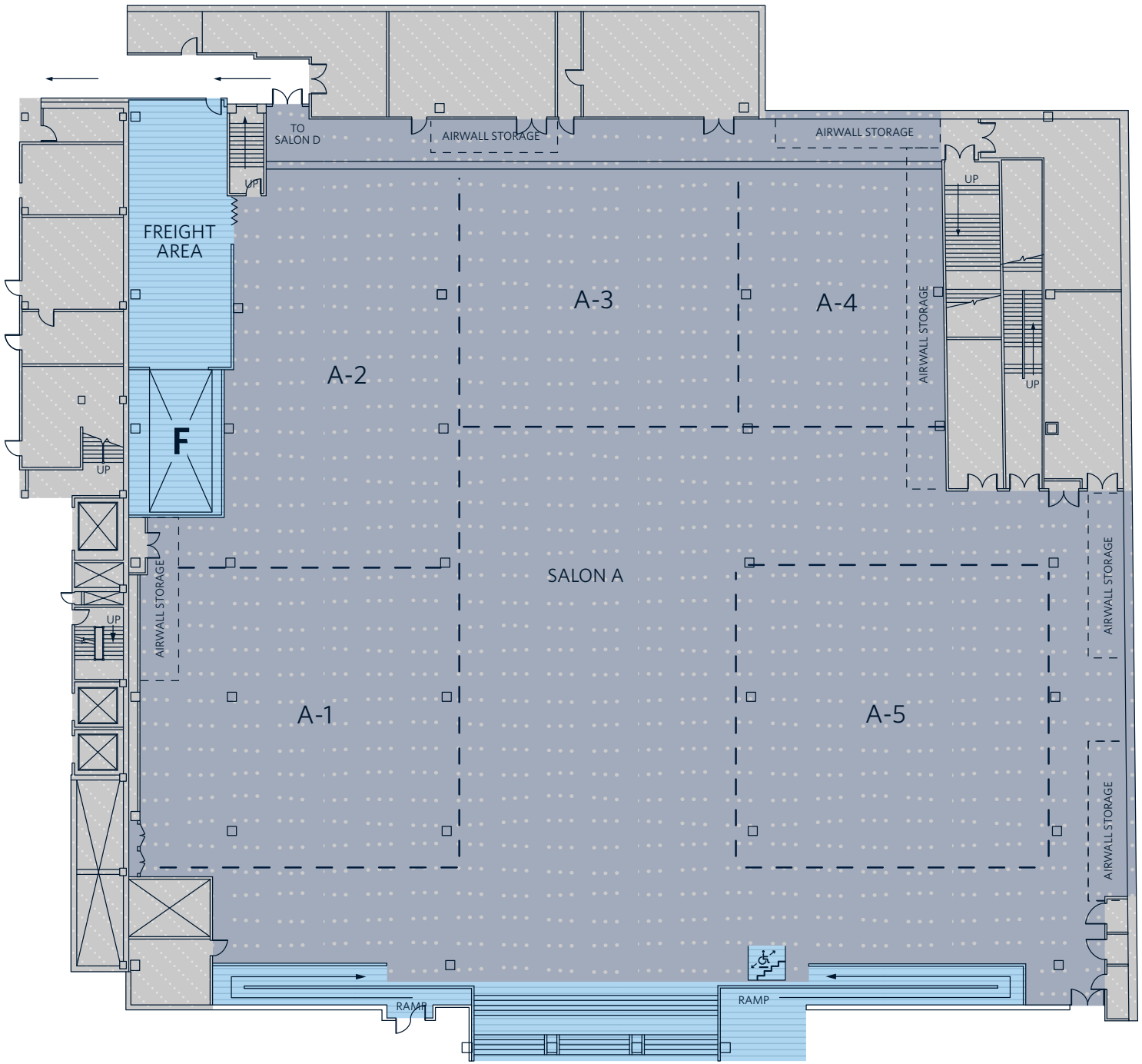

SALON A	Square Feet	Square Meters	Dimensions L x W	Ceiling Height Max*	Ceiling Height Max Meters	Ceiling Height Min.	Ceiling Height Min. Meters	Theater	School Room 2/6'	School Room 3/6'	Banquet 10/60"	Reception	Conference	8'x10' Booths	10'x10' Booths
Salon A	40,140	3729.13	195'x200'	11'4"	3.18	10'2"	3.10	2,950	570	855	2,000	3,000	n/a	144	139
Salon A, Pre-function	5,060	470.09	92'x55'	11'4"	3.18	10'2"	3.10	500	180	270	600	1,200	n/a	-	-
Salon A-1	3,844	357.12	55'x62'	11'4"	3.18	10'2"	3.10	330	120	180	300	360	40	-	-
Salon A-2	3,772	350.43	82'x46'	11'4"	3.18	10'2"	3.10	310	120	180	300	360	40	-	-
Salon A-3	2,916	270.91	54'x54'	11'4"	3.18	10'2"	3.10	290	106	159	250	340	40	-	-
Salon A-4	2,214	205.69	54'x41'	11'4"	3.18	10'2"	3.10	170	80	120	120	300	30	-	-
Salon A-5	3,965	368.36	65'x61'	11'4"	3.18	10'2"	3.10	360	132	198	320	425	40	-	-

*All capacities are based on usable square footage

**Ceiling height under airwalls is 10'2"



KEY

- | | |
|--|--|
|  Meeting/Conference Rooms |  ADA Elevator |
|  Amenities |  ADA Lift |
|  Heart of House |  Restrooms |
| |  Elevator |
| |  Freight Elevator |

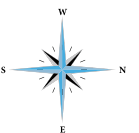

SALON C	Square Feet	Square Meters	Dimensions L x W	Ceiling Height	Ceiling Height Meters	Theater	School Room 2/6'	School Room 3/6'	Banquet 10/60"	Reception	Conference 2/6'	Conference 3/6'	Hollow Sq. 3/6'	U-Shape 3/6'
Salon C	28,906	1986.64	-	10'2"	3.10	-	-	-	1,000	-	-	-	-	-
Salon C, Pre-function	6,208	576.74	-	10'2"	3.10	-	-	-	500	600	-	-	-	-
Salon C, Office A	112	10.41	14'x8'	10'2"	3.10	-	-	-	-	-	-	-	-	-
Salon C, Office B	330	30.66	33'x10'	10'2"	3.10	-	-	-	-	-	-	-	-	-
Salon C-1	1,131	105.07	39'x29'	10'2"	3.10	83	30	45	60	75	24	34	48	39
Salon C-2	1,131	105.07	39'x29'	10'2"	3.10	66	24	36	80	60	20	28	42	33
Salon C-3	1,443	106.19	39'x37'	10'2"	3.10	120	40	60	90	100	24	34	54	42
Salon C-4	1,443	106.19	39'x37'	10'2"	3.10	105	32	48	90	90	20	28	48	36
Salon C-5	1,326	123.19	39'x37'	10'2"	3.10	120	38	57	90	100	24	34	48	39
Salon C-6	1,326	123.19	39'x34'	10'2"	3.10	105	30	45	90	90	20	28	42	33
Salon C-7	858	79.71	39'x22'	10'2"	3.10	70	30	45	70	60	24	34	42	36
Salon C-8	858	79.71	39'x22'	10'2"	3.10	66	30	45	60	60	20	28	36	30
Salon C-1,2	2,262	210.15	78'x29'	10'2"	3.10	171	60	90	180	150	44	64	78	69
Salon C-3,4	2,886	268.12	78'x37'	10'2"	3.10	255	80	120	220	240	44	64	84	72
Salon C-5,6	2,652	246.38	78'x34'	10'2"	3.10	255	74	111	220	240	44	64	78	69
Salon C-7,8	1,716	159.42	78'x22'	10'2"	3.10	150	62	108	150	125	44	64	72	66
Salon C-1,2,3,4	5,148	478.26	78'x66'	10'2"	3.10	426	140	210	400	400	-	-	-	-
Salon C-5,6,7,8	4,368	405.80	78'x56'	10'2"	3.10	405	146	219	370	385	-	-	-	-
Salon C-1,2,3,4,5,6,7,8	9,516	884.07	78'x122'	10'2"	3.10	-	-	-	770	700	-	-	-	-

All capacities are based on usable square footage
 Airwalls in Salon C cannot be reconfigured while meetings are in session

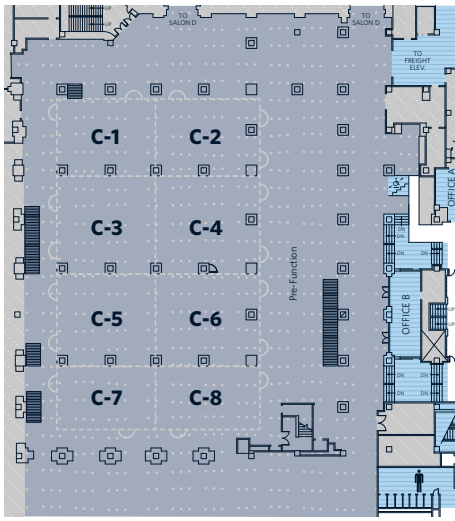

Salon C, Layout Option 1

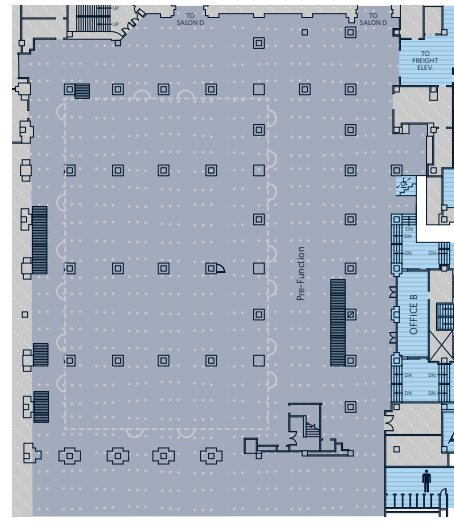

Salon C, Layout Option 4

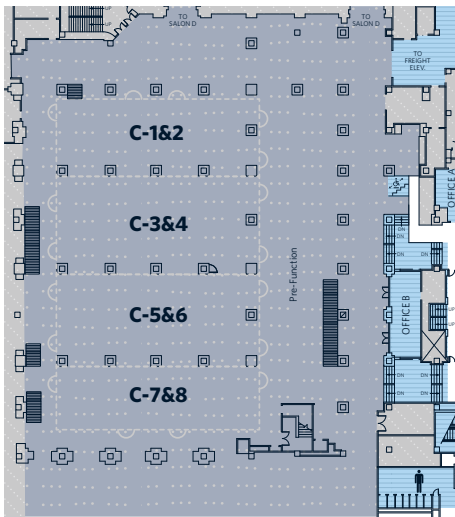

Salon C, Layout Option 2

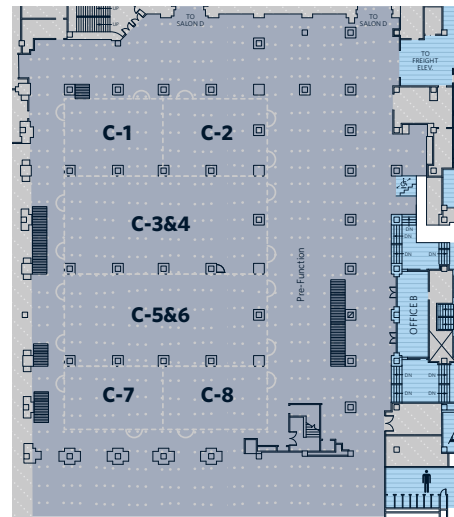

Salon C, Layout Option 5

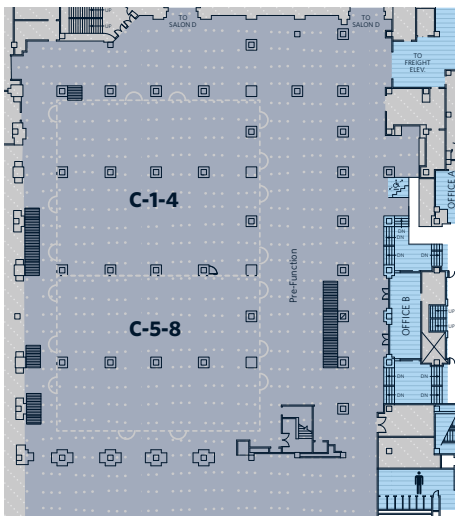

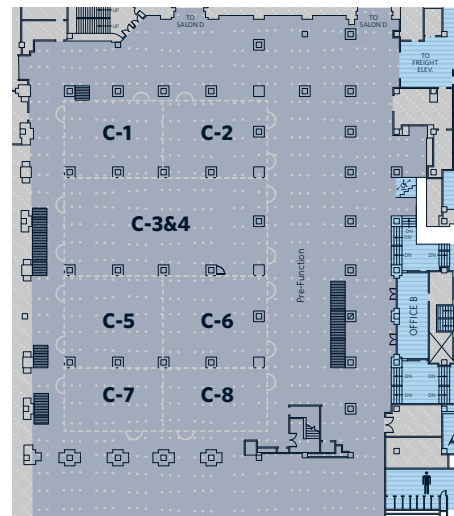

Salon C, Layout Option 3



Salon C, Layout Option 6

KEY

-  Meeting/Conference Rooms
-  Amenities
-  Heart of House

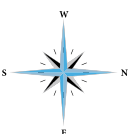

LOBBY LEVEL	Square Feet	Square Meters	Dimensions L x W	Ceiling Height	Ceiling Height Meters	Chandelier Clearance	Theater	School Room 2/6'	School Room 3/6'	Banquet 10/60"	Reception	Conference 2/6'	Conference 3/6'
Continental Room	10,080	936.46	144'x70'	12'	3.66	11'2"	990	398	597	900	1,350	-	-
Continental A	3,360	312.15	48'x70'	12'	3.66	11'2"	330	132	198	300	450	40	58
Continental B	3,360	312.15	48'x70'	12'	3.66	11'2"	330	132	198	300	450	40	58
Continental C	3,360	312.15	48'x70'	12'	3.66	11'2"	330	132	198	300	450	40	58
Continental Foyer	3,600	312.15	144'x25'	14'	4.27	10'5"	-	-	-	-	-	-	-
Continental North Office	231	21.46	11'x21'	9'	2.74	-	-	-	-	-	-	-	-
Continental South Office	231	21.46	11'x21'	9'	2.74	-	-	-	-	-	-	-	-
8th Street, North Reg/Office/ Coat Check	594	55.18	41'x17'	7'10"	2.16	-	-	-	-	-	-	-	-
8th Street North Counter	-	-	2'2"x25'	7'10"	2.16	-	-	-	-	-	-	-	-
8th Street South Reg/Office	290	26.94	18'x14'	8'4"	2.54	-	-	-	-	-	-	-	-
8th Street South Reg Counter	-	-	2'2"x32'3"	8'4"	2.54	-	-	-	-	-	-	-	-
8th Street West Office	220	20.44	19'x12'	8'11"	2.72	-	-	-	-	-	-	-	-
Grand Tradition	1,307	121.42	24'x68'	9'4"	2.84	-	85	28	42	60	125	20	28
Buckingham Room	2,317	215.26	61'x43'	10'3"	3.12	9'	104	40	60	80	125	24	34

All capacities are based on usable square footage

LOBBY LEVEL OUTLETS	Square Feet	Square Meters	Banquet 10/60"	Reception
*720 Dining, North	1,199	111.39	80	-
*720 Dining, South	1,531	142.23	80	-
*720 Dining, East	1,019	94.67	-	80
*720 Dining, PDR	188	17.47	12	-
720 Bar, South				
*Kitty O'Sheas, Shillelagh Room	-	-	-	25
*Kitty O'Sheas, Outdoor Seasonal Patio	-	-	72	72

*Using existing seating

SOUTH WABASH AVENUE

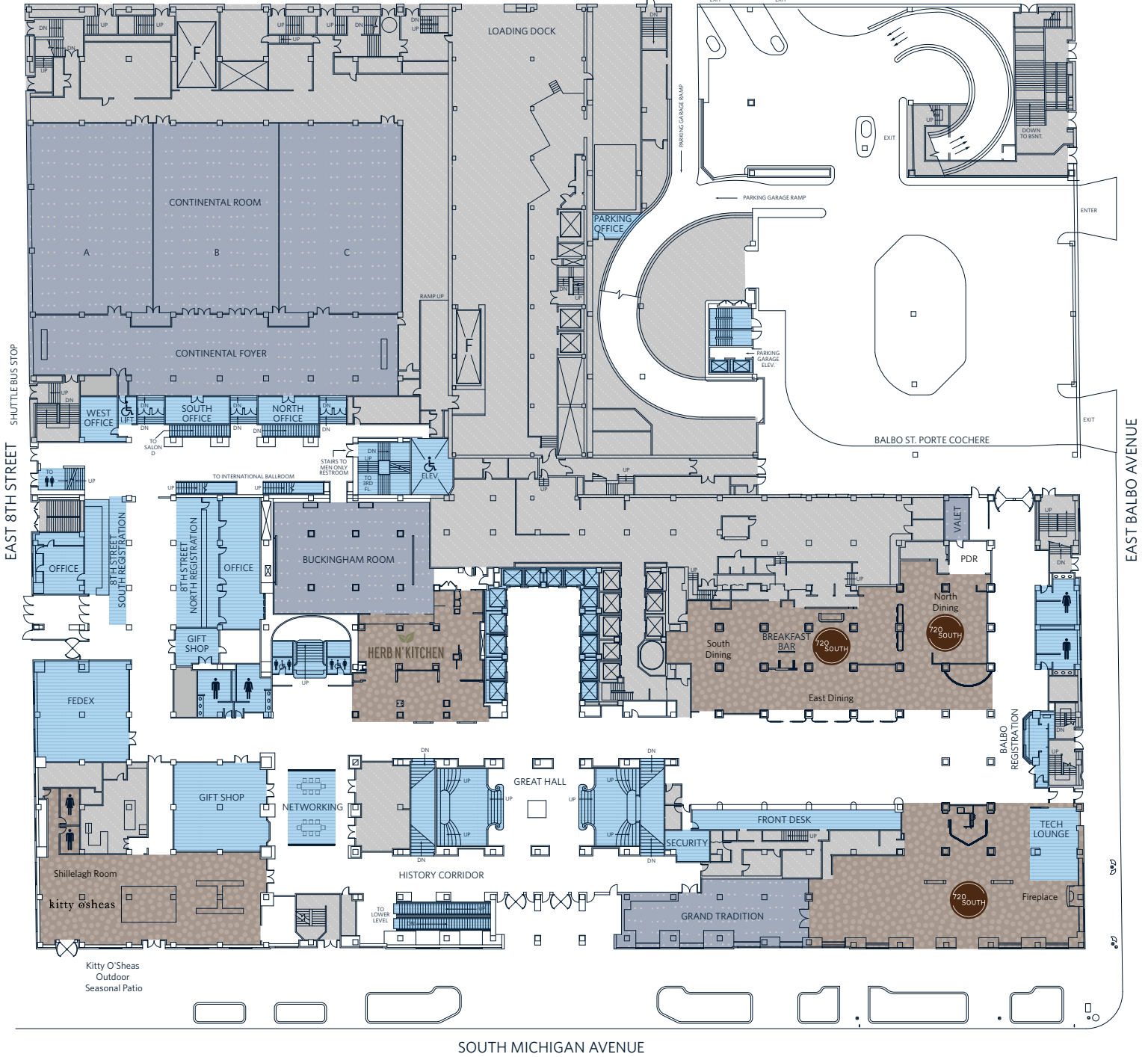

SOUTH MICHIGAN AVENUE

KEY

- Meeting/Conference Rooms
- Food & Beverages
- Amenities
- Heart of House
- ADA Elevator
- ADA Lift
- Restrooms
- Elevator
- Freight Elevator

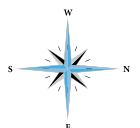

SECOND FLOOR	Square Feet	Square Meters	Dimensions L x W	Ceiling Height	Ceiling Height Meters	Chandelier Clearance	Chandelier Clearance Meters	Theater	School Room 2/6'	School Room 3/6'	Banquet 10/60"	Reception	Conference 2/6'	Conference 3/6'
Grand Ballroom	12,640	1174.29	158'x80'	34'	10.36	15'3"	4.65	1,450	600	900	1,100	1,453	-	-
Grand Ballroom Balcony	-		-	21'	6.40	-		200	-	-	80	180	-	-
Grand Ballroom Foyer	2,494	231.70	86'x29'	18'	5.49	8'9"	2.67	-	-	-	-	250	-	-
International Ballroom	21,996	2043.50	156'x141'	23'	7.01	19'4"	5.89	2,540	920	1,380	1,800	2,700	-	-
International North	13,395	1244.44	95'x141'	23'	7.01	19'4"	5.89	1,500	570	855	1,060	1,540	-	-
International South	8,601	799.06	61'x141'	23'	7.01	19'4"	5.89	920	334	501	680	900	-	-
International Foyer	1,854	172.24	103'x18'	11'	3.35	8'	2.44	-	-	-	-	-	-	-
International Dressing Room	417	38.74	17'4"x24'	-		-		-	-	-	-	-	-	-
Normandie Lounge	3,640	338.17	130'x28'	24'	7.32	12'	3.66	-	-	-	250	700	-	-
Boulevard Room	3,296	306.21	103'x32'	9'	2.74	8'6"	2.59	290	120	180	240	379	-	-
Boulevard A	1,152	107.02	36'x32'	9'	2.74	8'6"	2.59	90	36	54	70	120	20	28
Boulevard B	925	85.94	29'x32'	9'	2.74	8'6"	2.59	55	28	42	50	80	16	22
Boulevard C	1,216	112.97	38'x32'	9'	2.74	8'6"	2.59	120	40	60	80	130	20	28
Boulevard Foyer	1,080	100.34	36'x30'	9'	2.74	8'10"	2.46	-	-	-	-	125	-	-

All capacities are based on usable square footage

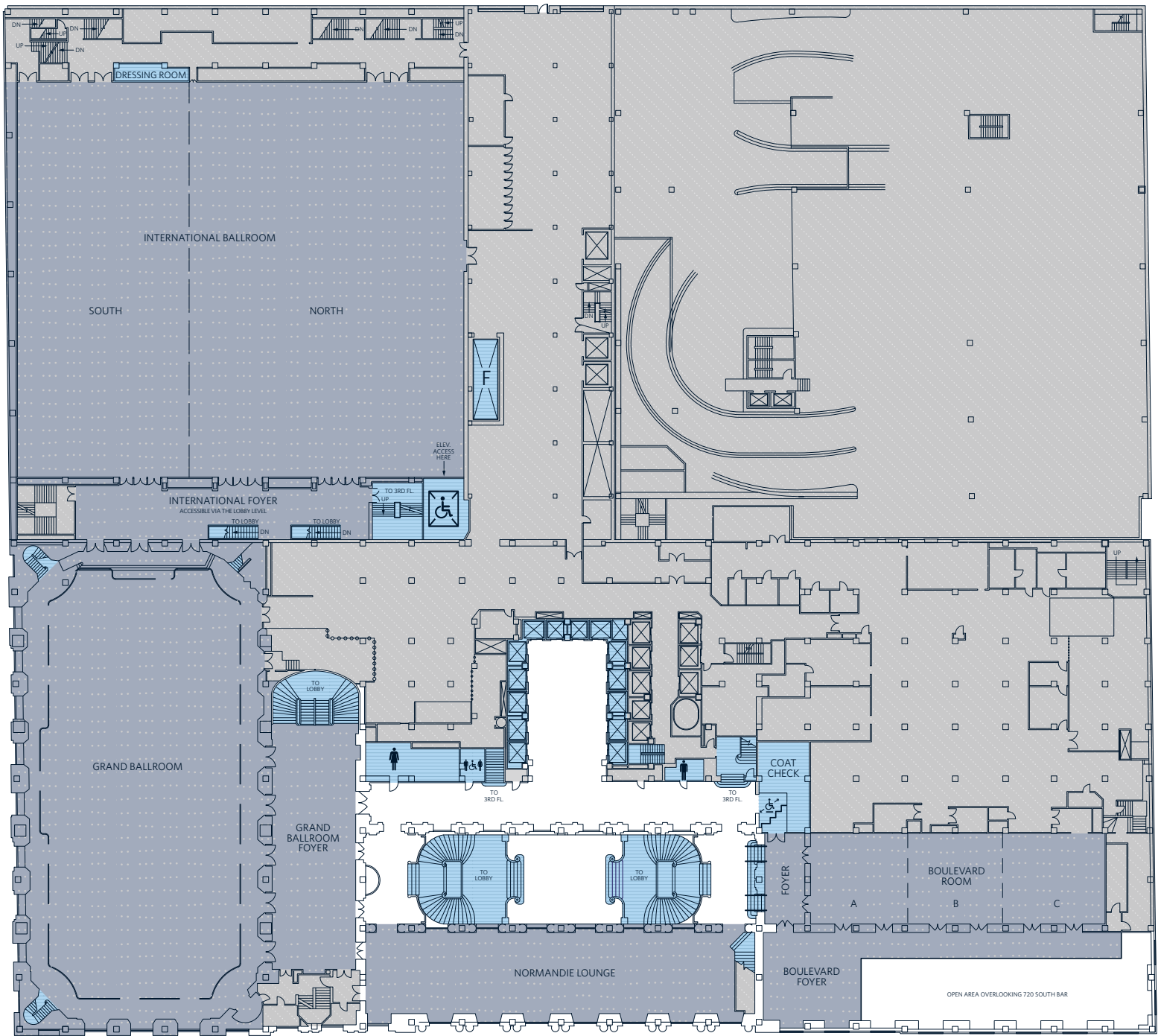

2ND FLOOR

KEY

- Meeting/Conference Rooms
- Amenities
- Heart of House
- ADA Elevator
- ADA Lift
- Restrooms
- Elevator
- Freight Elevator

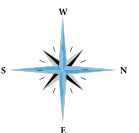

THIRD FLOOR	Square Feet	Square Meters	Dimensions L x W	Ceiling Height	Ceiling Height Meters	Chandelier Clearance	Chandelier Clearance Meters	Column Sizes	Theater	School Room 2/6'	School Room 3/6'	Banquet 10/60"	Reception	Conference 2/6'	Conference 3/6'
Waldorf Room	3,456	321.07	72'x48'	14'	4.27	9'11"	3.02	2'8"x2'4"	380	108	162	220	350	32	46
Astoria Room	1,518	141.03	46'x33'	11'	3.07	9'6"	2.90	2'5"x2'3"	90	34	51	90	140	25	34
Williford Room	7,192	668.16	116'x62'	9'6"	2.90	7'1"	2.16	2'6"x2'6"	610	200	300	650	700	-	-
Williford A	2,108	195.84	34'x62'	9'6"	2.90	7'1"	2.16	-	187	66	99	160	200	30	40
Williford B	2,108	195.84	34'x62'	9'6"	2.90	7'1"	2.16	-	187	66	99	160	200	30	40
Williford C	2,976	276.48	48'x62'	10'	3.05	7'1"	2.16	-	236	100	150	280	300	46	64
Marquette Room	2,015	187.20	65'x31'	10'2"	3.10	7'11"	2.41	-	200	84	126	170	200	46	64
Marquette Foyer	364	33.82	28'x13'	10'	3.05	7'6"	2.29	-	-	-	-	-	-	-	-
Joliet Room	1,058	98.29	46'x23'	10'2"	3.10	7'3"	2.21	-	80	40	60	80	100	30	40
Joliet Foyer	429	39.86	33'x13'	9'6"	2.90	7'	2.13	-	-	-	-	-	-	-	-
PDR #1	640	59.46	16'x40'	9'6"	2.90	7'5"	2.26	-	40	20	30	40	50	22	28
PDR #2	1,120	104.05	28'x40'	9'6"	2.90	7'5"	2.26	-	90	48	72	80	100	24	34
PDR #3	600	55.74	15'x40'	9'6"	2.90	7'2"	2.18	-	50	20	30	40	50	22	28
PDR #4	833	77.39	24'x34'7"	9'6"	2.90	7'2"	2.18	3'x4'	60	26	39	60	75	22	28
PDR #5	360	33.45	24'x15'	9'6"	2.90	7'5"	2.26	-	30	8	12	20	20	16	22
PDR #6	360	33.45	24'x15'	9'6"	2.90	7'5"	2.26	-	30	8	12	20	20	16	22
PDR #7	360	33.45	24'x15'	9'6"	2.90	7'5"	2.26	-	30	8	12	20	20	16	22

All capacities are based on usable square footage

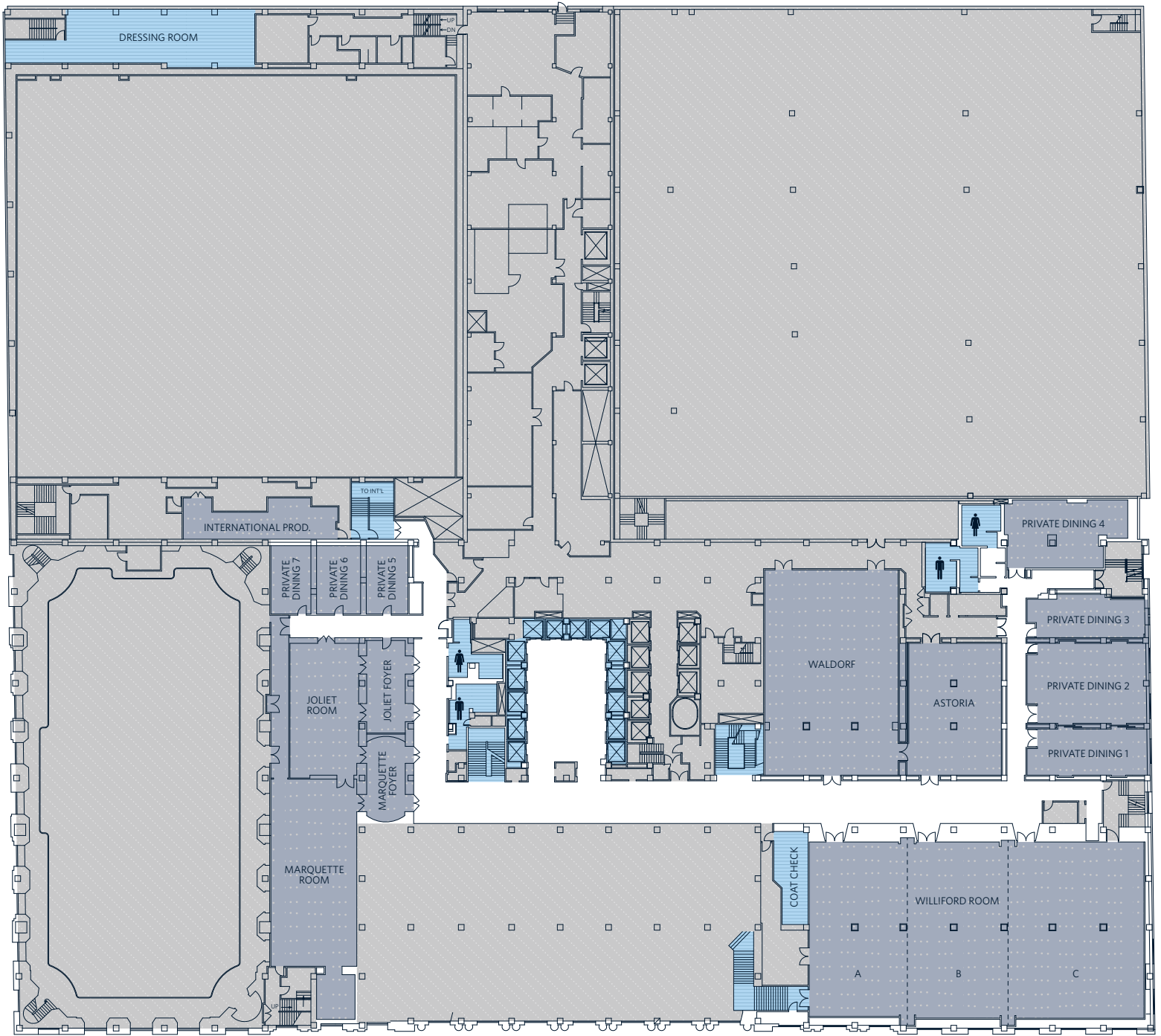

KEY

- Meeting/Conference Rooms
- Amenities
- Heart of House
- ♂
♀
 Restrooms
- X
 Elevator

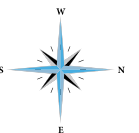

FOURTH FLOOR	Square Feet	Square Meters	Dimensions L x W	Ceiling Height	Ceiling Height Meters	Column Sizes	Theater	School Room 2/6'	School Room 3/6'	Banquet 10/60"	Reception	Conference 2/6'	Conference 3/6'
Conference Room 4A	480	44.59	32'x15'	8'1"	2.46	-	50	16	24	30	45	20	28
Conference Room 4B	432	40.13	27'x16'	8'1"	2.46	-	44	12	18	30	45	16	22
Conference Room 4C	728	67.63	52'x14'	8'1"	2.46	-	75	16	24	50	75	28	40
Conference Room 4D	960	89.19	40'x24'	8'1"	2.46	3'7"x2'1"	80	26	39	50	75	24	34
Conference Room 4E	378	35.12	27'x14'	8'1"	2.46	-	40	12	18	30	45	16	22
Conference Room 4F	459	42.64	27'x17'	8'1"	2.46	-	45	16	24	30	45	16	22
Conference Room 4G	448	41.62	28'x16'	8'1"	2.46	-	36	8	12	30	45	16	22
Conference Room 4H	368	34.19	23'x16'	8'1"	2.46	-	30	8	12	20	30	16	22
Conference Room 4I	322	29.91	23'x14'	8'1"	2.46	-	26	8	12	20	30	16	22
Conference Room 4J	375	34.84	25'x15'	8'1"	2.46	-	30	8	12	20	30	16	22
Conference Room 4K	600	55.74	40'x15'	8'1"	2.46	-	48	20	30	40	60	20	28
Conference Room 4L	435	40.41	29'x15'	8'1"	2.46	-	34	16	24	30	45	16	22
Conference Room 4M	765	71.07	45'x17'	8'1"	2.46	-	80	26	39	50	75	24	34
Conference Room 4P	293	27.22	18'x17'	8'6"	2.59	-	24	6	9	20	30	12	16
Conference Room 4Q	378	35.12	27'x14'	8'6"	2.59	-	40	12	18	30	45	16	22
Conference Room 4R	336	31.22	27'x14'	8'6"	2.59	-	24	8	12	30	45	16	22
McCormick Boardroom	595	55.28	35'x17'	7'10"	2.16	-	-	-	-	-	-	22	22
Pullman Boardroom	510	47.38	30'x17'	7'10"	2.16	-	-	-	-	-	-	20	20

All capacities are based on usable square footage

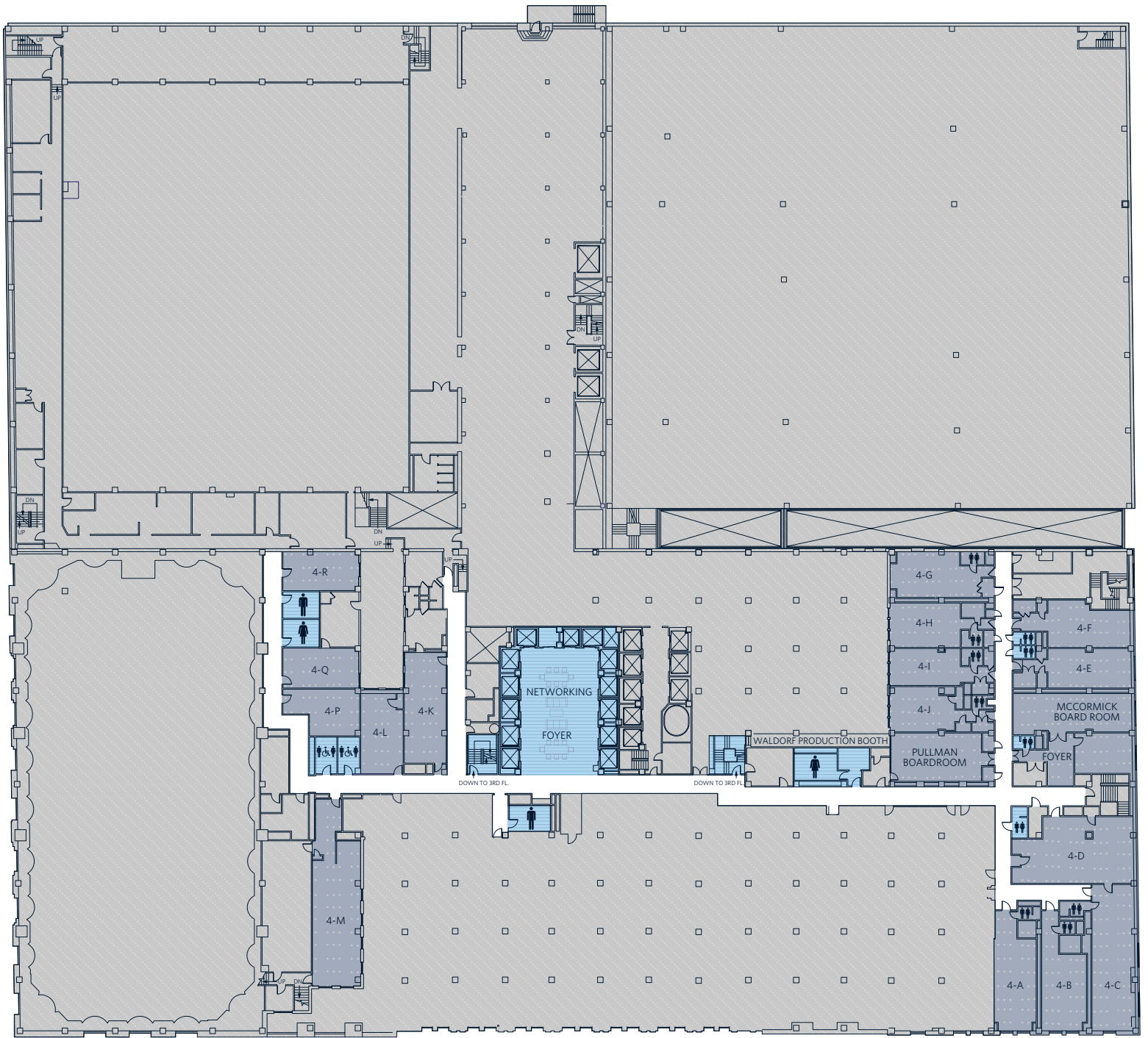

KEY

- Meeting/Conference Rooms
- Amenities
- Heart of House
- ♂ ♀
 Restrooms
- X
 Elevator

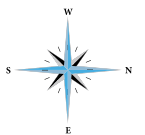

FIFTH FLOOR

	Square Feet	Square Meters	Dimensions L x W	Ceiling Height	Ceiling Height Meters	Theater	School Room 2/6'	School Room 3/6'	Banquet 10/60"	Reception	Conference 2/6'	Conference 3/6'
Conference Room 5A	260	24.15	20'x13'	7'9"	2.36	18	8	12	20	20	10	16
Conference Room 5B	260	24.15	20'x13'	7'9"	2.36	18	8	12	20	20	10	16
Conference Room 5C	312	28.99	24'x13'	7'9"	2.36	18	8	12	20	20	10	16
Conference Room 5D	312	28.99	24'x13'	7'9"	2.36	18	8	12	20	20	10	16
Conference Room 5E	350	32.52	25'x14'	7'9"	2.36	27	12	18	30	34	14	22
Conference Room 5F	336	31.22	24'x14'	7'9"	2.36	30	12	18	30	39	14	22
Conference Room 5G	322	29.91	23'x14'	7'9"	2.36	30	12	18	20	37	14	22
Conference Room 5H	390	36.23	26'x15'	7'9"	2.36	32	14	21	30	43	14	22
Conference Room 5I	299	27.78	23'x13'	7'9"	2.36	25	8	18	20	34	10	16

All capacities are based on usable square footage

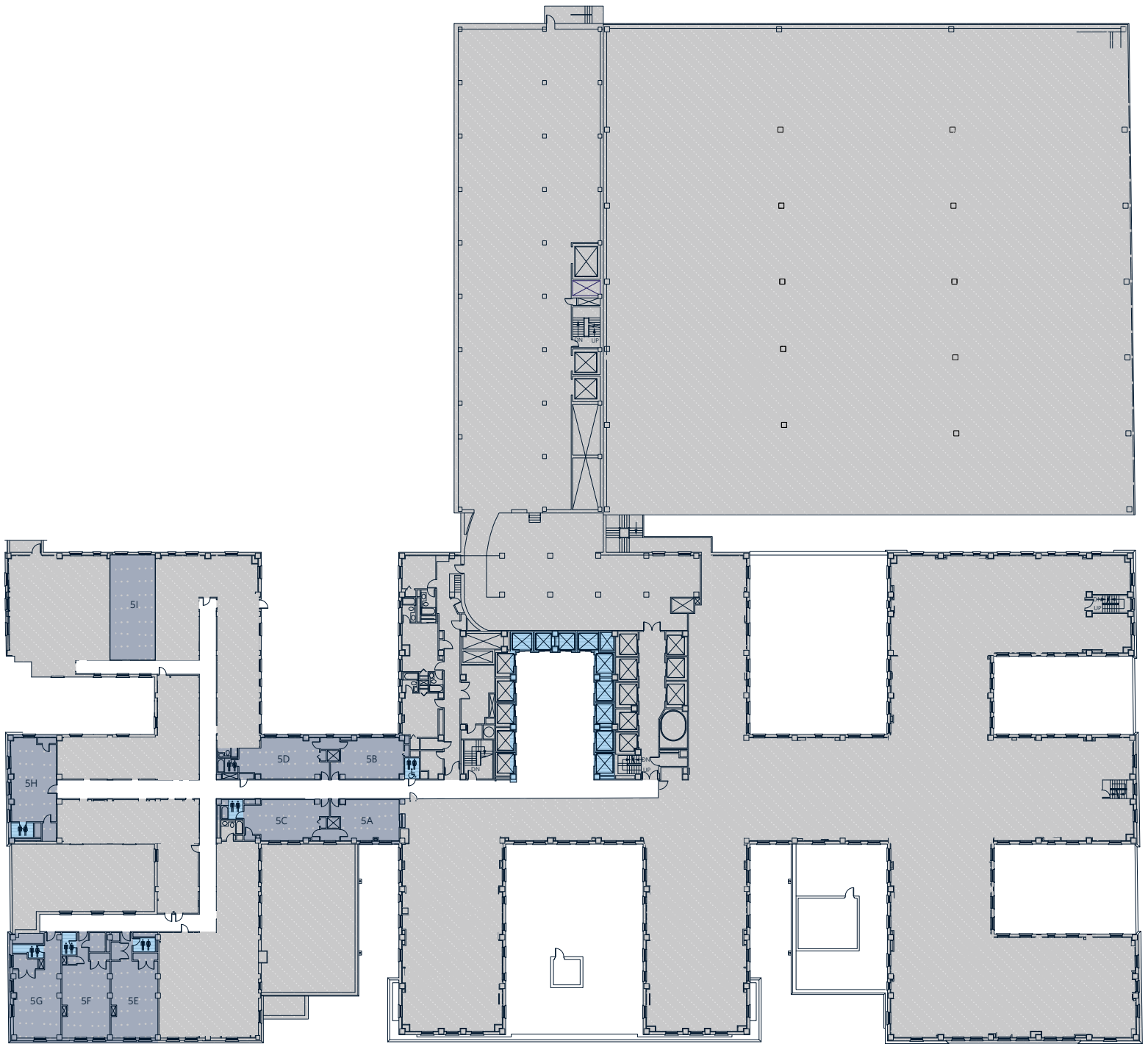

KEY

- Meeting/Conference Rooms
- Amenities
- Heart of House
- E
 Elevator
- R
 Restrooms

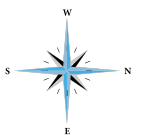



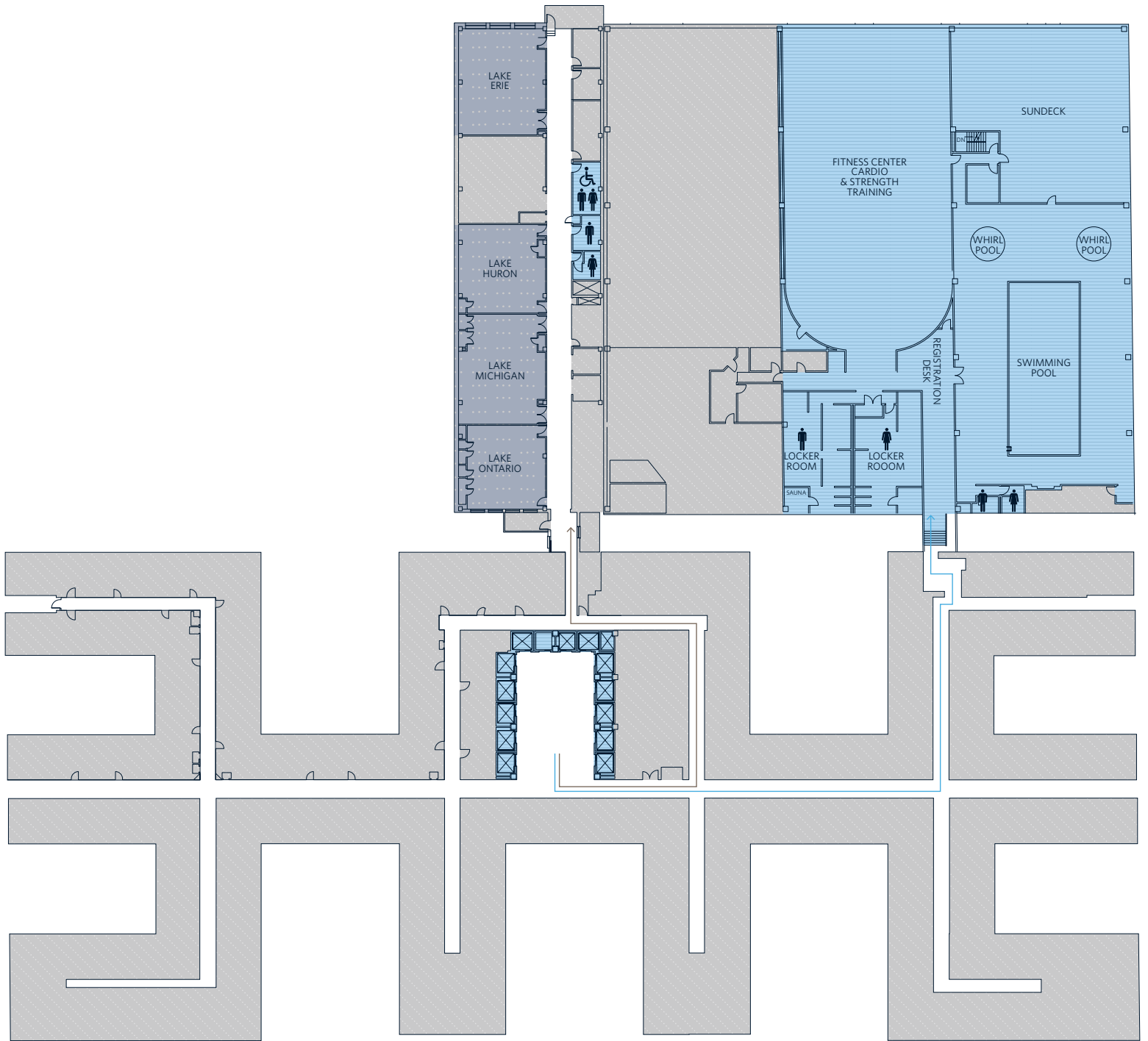

EIGHTH FLOOR

	Square Feet	Square Meters	Dimensions L x W	Ceiling Height	Ceiling Height Meters	Theater	School Room 2/6'	School Room 3/6'	Banquet 10/60"	Reception	Conference 2/6'	Conference 3/6'
Lake Ontario	930	86.40	30'x31'	8'	2.44	90	32	48	70	120	20	28
Lake Michigan	1,240	115.20	40'x31'	8'	2.44	140	40	60	90	150	24	34
Lake Huron	930	86.40	30'x31'	8'	2.44	90	32	48	60	120	20	28
Lake Erie	1,178	109.44	38'x31'	8'	2.44	130	40	60	90	150	22	28
Athletic Club Sundeck	3,360	312.15	62'x45'	-	-	-	-	-	50	50	-	-

All capacities are based on usable square footage

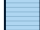

KEY

- | | |
|--|---|
|  Meeting/Conference Rooms |  Restrooms |
|  Amenities |  Elevator |
|  Heart of House | |

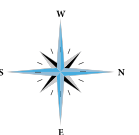

TWENTY FOURTH FLOOR

Reception



Grant Park Parlour

50

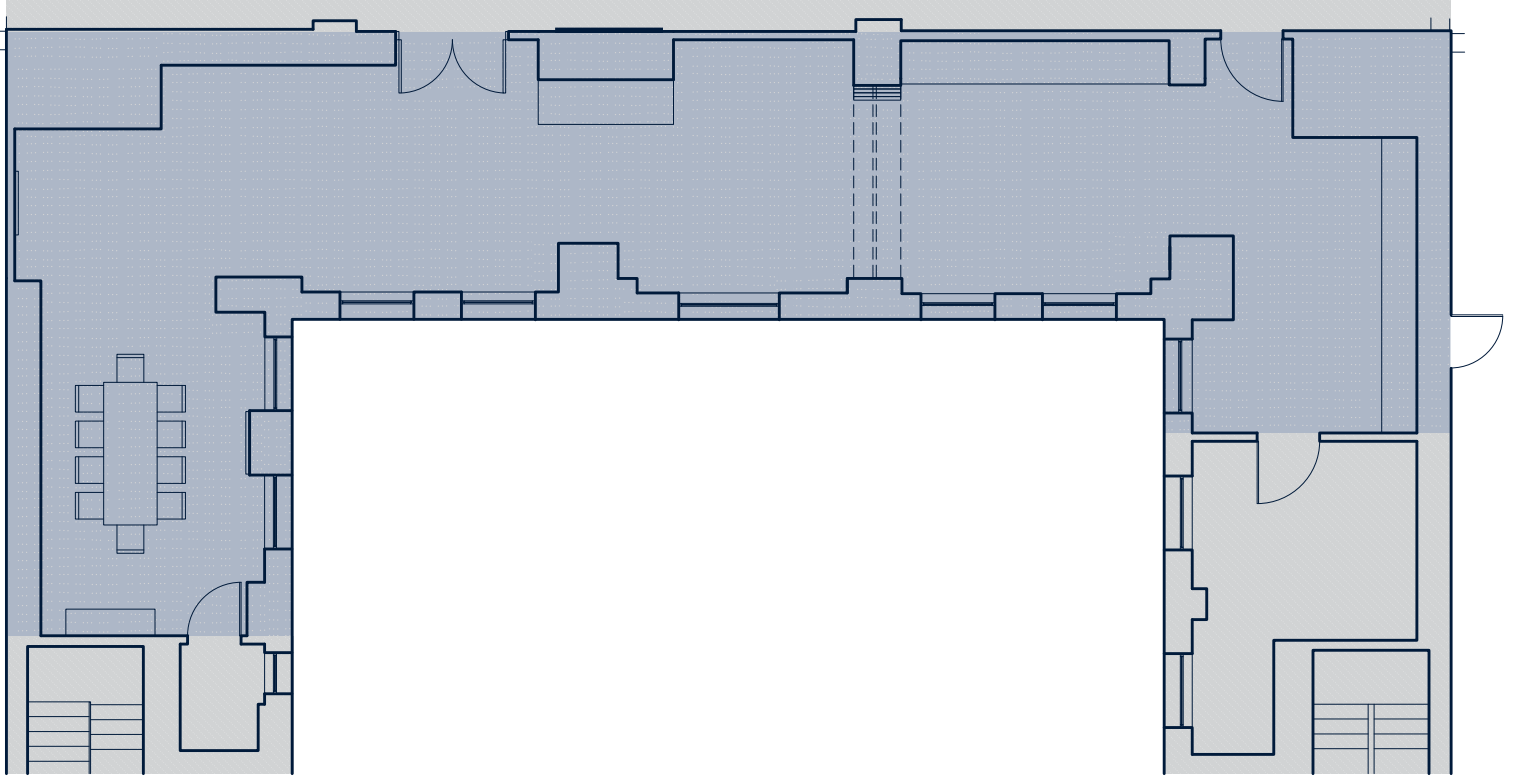
All capacities are based on usable square footage



KEY

- | | |
|--|--|
|  Meeting/Conference Rooms |  ADA Elevator |
|  Amenities |  ADA Lift |
|  Heart of House |  Restrooms |
| |  Elevator |
| |  Freight Elevator |

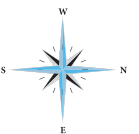

1946 - Hilton Hotels Corporation is formed and Hilton Chicago becomes the corporate headquarters.

1927 - Hotel hosts the Motion Picture Association Ball (2 days after opening) serving 3,000 movie stars and legendary presenter, director Cecil B. de Mille.

1945 - Conrad Hilton purchased The Stevens Hotel for \$7.5 million.

1960 - During The 1960 Republican convention, a Great Ladies Luncheon Tableau was presented.

1962 - The hotel opened the Hilton Center, adding a massive 75,000 sq ft of function space, becoming the largest meeting facility in the world



1927



1959



1960



1945



1951



1942



1959

1927 - The Stevens Hotel, later known as the Hilton Chicago, opens with 3,000 guestrooms and welcomes the Vice President of the time, Charles G. Dawes as its first registered guest.

1942 - During World War II, the hotel was taken over by the military to be used by the Army Armed Forces as a Technical Training School.

1948 - The Boulevard Supper Club opens featuring elaborate ice shows and rumored it's legendary maitre d' Phil Itta created the Shirley Temple

1959 - The hotel established a Guinness World Record for the LARGEST NUMBER OF PEOPLE AT A MEAL - 7,200

1959 - Queen Elizabeth II visits the hotel for dinner held in her honor, sponsored by the City of Chicago

1951 - The hotel is renamed The Conrad Hilton.



1948

1989 - Present: Hilton Chicago becomes a star having appeared in The Package, The Fugitive, Home Alone II, My Best Friend's Wedding, Road to Perdition, Primal Fear, Little Fockers, ER, Chicago PD, Chicago Fire, Empire

2008 - Former President Obama's cabinet selection occurred in the Waldorf Room

2009 - The hotel holds its EIGHTH Presidential Press Conference

1994 - Hotel renamed Hilton Chicago

1962

1989

2008

2013

2013 - The Conrad Hilton Suite underwent a \$1.8 million renovation

2011

1994

2011

1976

1985

2008

est. 1927

1969

1984

1976 - King Gustav of Sweden visits the hotel while in Chicago.

2008 - Home to 150 of the 2008 USA Summer Olympians, during their appearance on the Oprah Show

1969 - Commemorative luncheon for the crew of Apollo 8

1984 - The largest most expensive (\$185 million) hotel renovation ever undertaken

2011 - Hotel embarks on a \$150 million renovation, completed during the winter of 2017

1985 - The Hilton Chicago & Towers re-opens

2011 - Hosted welcome dinner for Chinese President Hu Jintao



NOTES



HILTON CHICAGO
720 South Michigan Avenue | Chicago, IL 60605
T: +1 312.922.4400
www.hiltonchicagomeetings.com

